

EXIMPORT Conexões de Ferro Maleável

60135

Tubos compatíveis	Aço carbono sem costura
Pressão máx. de trabalho	Até 140 bar (2.000 psi)
Vedação	Rosca

União assento de bronze

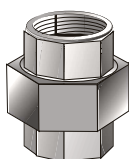

Rosca	Referência	Peso Aprox. (kg)
1/4" NPT	702.070.004	0,138
3/8" NPT	702.070.006	0,205
1/2" NPT	702.070.007	0,305
3/4" NPT	702.070.009	0,508
1" NPT	702.070.010	0,674
1.1/4" NPT	702.070.011	0,976
1.1/2" NPT	702.070.012	1,267
2" NPT	702.070.020	1,919

Te

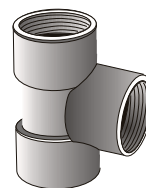

Rosca	Referência	Peso aprox. (kg)
1/4" NPT	702.060.004	0,118
3/8" NPT	702.060.006	0,179
1/2" NPT	702.060.007	0,285
3/4" NPT	702.060.009	0,459
1" NPT	702.060.010	0,670
1.1/4" NPT	702.060.011	1,055
1.1/2" NPT	702.060.012	1,361
2" NPT	702.060.020	2,260

Niple duplo

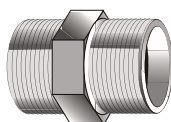

Rosca	Referência	Peso aprox. (kg)
1/4" NPT	702.001.004	0,040
3/8" NPT	702.001.006	0,043
1/2" NPT	702.001.007	0,101
3/4" NPT	702.001.009	0,134
1" NPT	702.001.010	0,249
1.1/4" NPT	702.001.011	0,381
1.1/2" NPT	702.001.012	0,481
2" NPT	702.001.020	0,769

Luva



Rosca	Referência	Peso aprox. (kg)
1/4" NPT	702.045.004	0,075
3/8" NPT	702.045.006	0,112
1/2" NPT	702.045.007	0,175
3/4" NPT	702.045.009	0,278
1" NPT	702.045.010	0,423
1.1/4" NPT	702.045.011	0,681
1.1/2" NPT	702.045.012	0,836
2" NPT	702.045.020	1,444

Cotovelo 90°

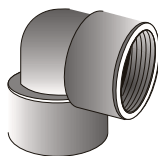

Rosca	Referência	Peso aprox. (kg)
1/4" NPT	702.015.004	0,080
3/8" NPT	702.015.006	0,128
1/2" NPT	702.015.007	0,196
3/4" NPT	702.015.009	0,312
1" NPT	702.015.010	0,512
1.1/4" NPT	702.015.011	0,761
1.1/2" NPT	702.015.012	0,999
2" NPT	702.015.020	1,582

Cotovelo 45°

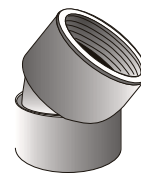

Rosca	Referência	Peso aprox. (kg)
1/4" NPT	702.025.004	0,067
3/8" NPT	702.025.006	0,116
1/2" NPT	702.025.007	0,191
3/4" NPT	702.025.009	0,282
1" NPT	702.025.010	0,451
1.1/4" NPT	702.025.011	0,695
1.1/2" NPT	702.025.012	0,947
2" NPT	702.025.020	1,382

Te de Redução

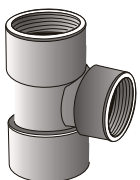

Rosca	Referência	Peso aprox. (kg)
1/2" x 1/4" NPT	702.065.074	0,232
1/2" x 3/8" NPT	702.065.076	0,248
3/4" x 3/8" NPT	702.065.096	0,347
3/4" x 1/2" NPT	702.065.097	0,385
1" x 1/2" NPT	702.065.107	0,563
1.1/4" x 3/4" NPT	702.065.119	0,852
1.1/2" x 1" NPT	702.065.121	1,138
2" x 1.1/4" NPT	702.065.211	1,265
2" x 1.1/2" NPT	702.065.212	1,907

Luva de redução

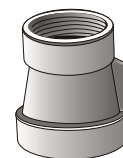

Rosca	Referência	Peso aprox. (kg)
1/2" x 1/4" NPT	702.050.074	0,126
1/2" x 3/8" NPT	702.050.076	0,140
3/4" x 3/8" NPT	702.050.096	0,186
3/4" x 1/2" NPT	702.050.097	0,214
1" x 1/2" NPT	702.050.107	0,299
1.1/4" x 3/4" NPT	702.050.119	0,478
1.1/2" x 1" NPT	702.050.121	0,654
2" x 1.1/4" NPT	702.050.211	1,065
2" x 1.1/2" NPT	702.050.212	1,138

Bucha de redução

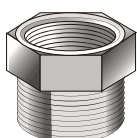

Rosca	Referência	Peso aprox. (kg)
1/2" x 1/4" NPT	702.002.074	0,051
1/2" x 3/8" NPT	702.002.076	0,040
3/4" x 3/8" NPT	702.002.096	0,079
3/4" x 1/2" NPT	702.002.097	0,067
1" x 1/2" NPT	702.002.107	0,143
1.1/4" x 3/4" NPT	702.002.119	0,230
1.1/2" x 1" NPT	702.002.121	0,281
2" x 1.1/4" NPT	702.002.211	0,415
2" x 1.1/2" NPT	702.002.212	0,370

Bujão

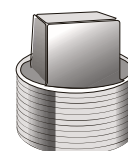

Rosca	Referência	Peso aprox. (kg)
1/4" NPT	702.010.004	0,014
3/8" NPT	702.010.006	0,028
1/2" NPT	702.010.007	0,051
3/4" NPT	702.010.009	0,075
1" NPT	702.010.010	0,136
1.1/4" NPT	702.010.011	0,198
1.1/2" NPT	702.010.012	0,260
2" NPT	702.010.020	0,415

Sujeito a alterações sem prévio aviso.

DISTRIBUIDOR

GARTEC SISTEMAS DE LUBRIFICAÇÃO LTDA-ME

Rua Barrinha, 196 - Bairro Jaraguá
Belo Horizonte - MG - CEP 31270-070
Tel.: (31) 3441-8257 - Fax: (31) 3441-1914
e-mail: gartec@gartec.com.br

